

iMARC Tag Rotating Easel Assembly

Step: 1

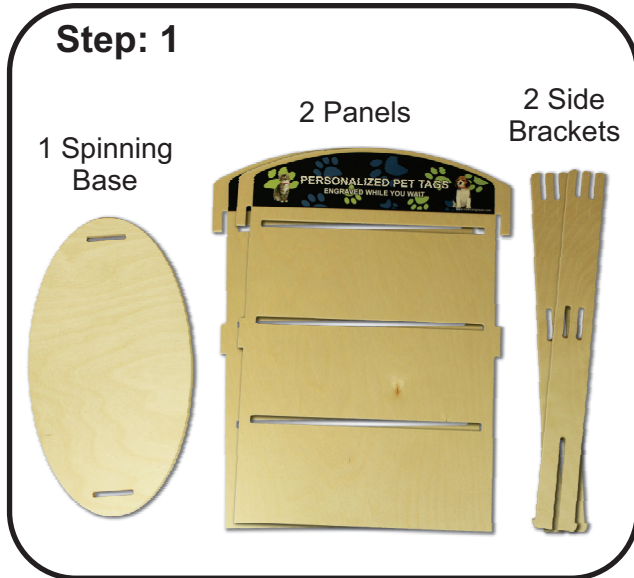

Ensure you have all items above.

Step: 2

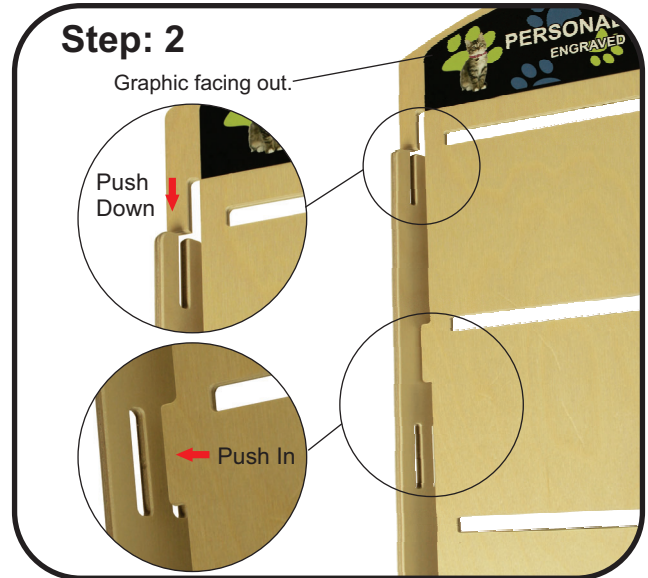

Carefully slide the side of the panel into the slots of the side bracket. Do this with both panels and both brackets.

Step: 3

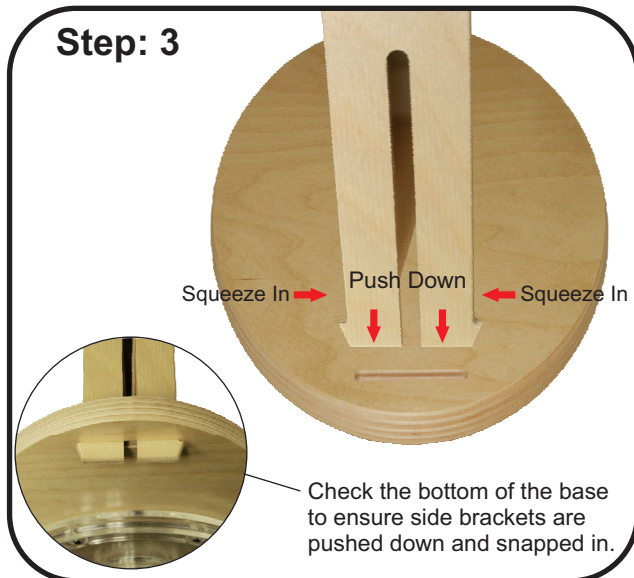

Insert the side brackets in to the base by squeezing the bottom of the bracket while pushing it down into the open slot in the base. Do this for both sides.

Step: 4



Check that all brackets and panels are tightly connected and free of gaps.

